



**waterbloc**<sup>™</sup>  
GRP WETROOM SOLUTION

# waterbloc

is unique blend of glass reinforced plastic (GRP) for use in wetrooms and bathrooms which forms a waterproof barrier under tiles.

Waterblo

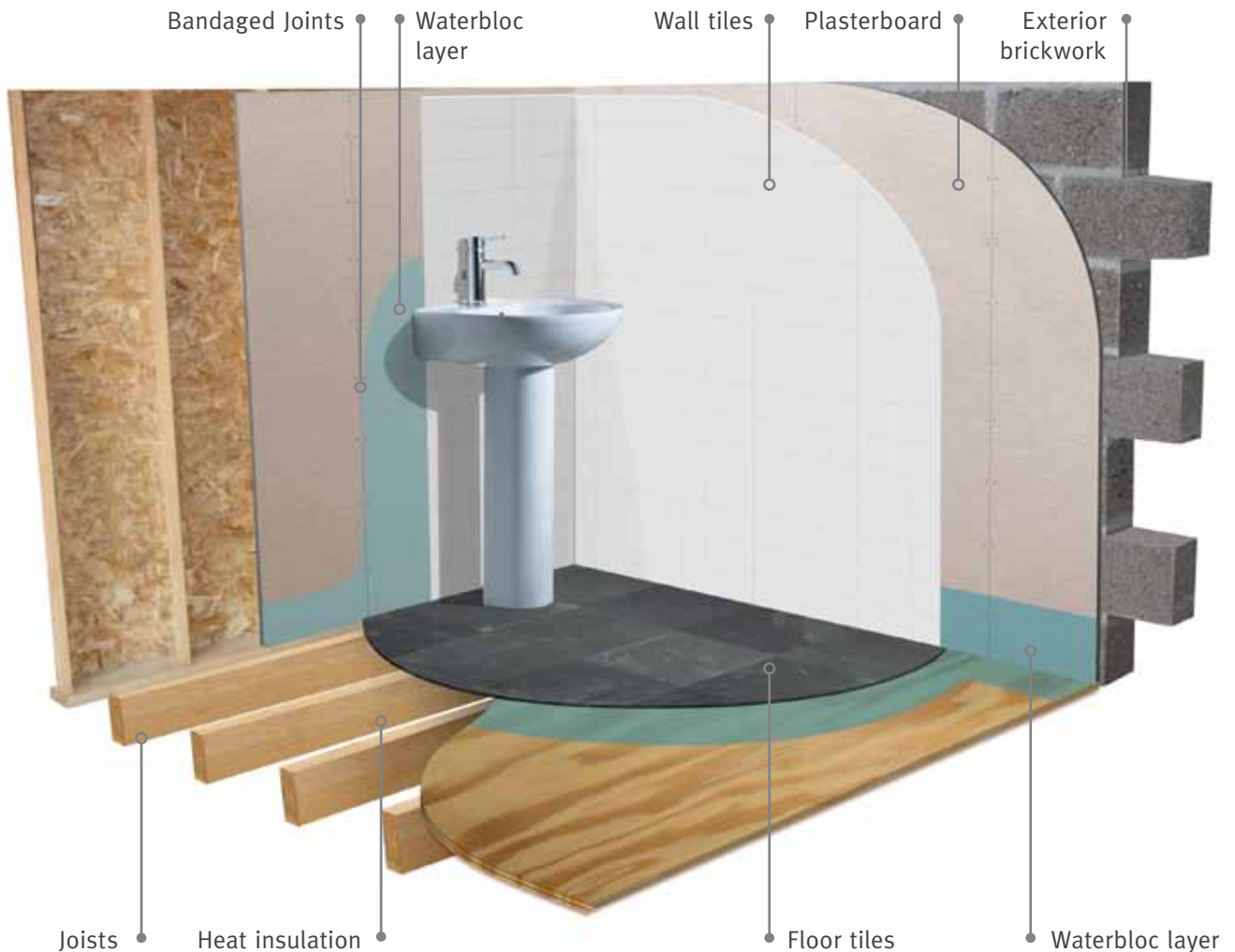

## Why Waterbloc?

GRP is waterproof, tough and maintenance free, making it well suited for external and internal applications. It's also hygienic, resistant to mould and is able to cope with normal structural movement. GRP is used in the manufacture of boats, Gliders, sports cars, fluid tanks, wind turbine blades and flat roofs all over the world.

[www.waterbloc.com](http://www.waterbloc.com)



Safe with all types of underfloor heating

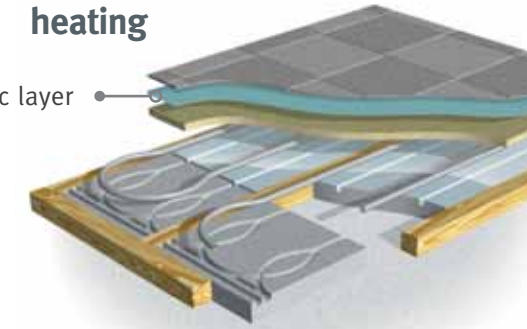

Expertly applied to walls and floor surfaces, beneath tiles, Waterbloc permanently protects your home from water damage.

Water can soak through tiles, grout and between sealed joins causing expensive damage to your home. It's essential to protect your wetroom with a tough waterproof barrier.

Waterbloc GRP is a flexible, permanent solution to interior waterproofing which does not leak, buckle or crack – creating clean smooth finish which can be tiled. Our experienced installers can apply Waterbloc GRP to any size or shape room.



# waterproofing indoors

**Q: How much will a watertight room cost?**

**A:** Every job is bespoke and priced individually. A quote is based on a cost per sq meter. Call your local installer for a free quote.

**Q: How long will the installation take?**

**A:** Each job varies depending on it's size however as a guide most rooms can be sealed within a day.

**Q: What state should the room be in?**

**A:** The room should be dry, free of dirt and dust and be as empty as possible.

**Q: Does your work carry any guarantees?**

**A:** Yes, everything we install is protected by our guarantee plus our own company guarantee. If you wish to see our guarantee in detail please ask, we'll be happy to talk you through it.

**Q: How long does the material take to dry?**

**A:** Waterbloc GRP is water repellent after one hour from fitting. You should leave 24 hours before tiling.

**Q: I'd like you to make my room watertight, what should I do next?**

**A:** Congratulations, you've made a good choice. All you have to do is ring your local installer (see below) below and they'll arrange a suitable time to come and give your property a survey, then the installation will be booked in at a time that's convenient with you.

[www.waterbloc.com](http://www.waterbloc.com)

Call your local **waterbloc** installer today for a free quote!



**FUTURE  
ROOF**

- GRP/Fibreglass specialists
- Expert wetroom advice
- Commercial and domestic
- Friendly local business

**01904 777094**

